

# F200 Plastisol



F200 Plastisol is pre-painted steel coated with a 200 micron, leather grain embossed Plastisol. F200 Plastisol combines high wear resistance with high durability against corrosion.

Historically, Plastisol has been used widely within the UK on a range of buildings and applications. Over the years the performance requirements for Plastisol have evolved to require longer guarantees and enhanced performance. As the demands have evolved so has our F200 Plastisol.

F200 Plastisol has been developed in partnership with our trusted supply partners to offer a mill backed guarantee available for up to 30 years.\*

F200 combines high wear resistance with high durability against corrosion. With a corrosion rating of RC5 and superior durability when exposed to foot traffic and other roof stresses, F200 Plastisol exceeds the standard required for a building envelope.

We stock F200 Plastisol at our Brighthouse facility in an extensive spectrum of colours, with the ability to source material to almost every RAL code.

## Features

- 30 Year Guarantee available\*
- Leather Grain embossed texture finished
- Suitable for roof pitches down to 4°
- High colour and gloss stability
- High build primer with excellent corrosion resistance
- Excellent formability
- Comprehensive colour range
- Factory cut edges covered under the guarantee

## Technical Properties

Coating Guarantee	30 Years*
Coating Thickness	200 Micron
Reverse Coating	12 Microns
Coating Embossing	Leather Grain
Scratch Resistance	45N
UV Radiation Resistance	Ruv3
Corrosion Resistance	RC5
Stain Resistance	Satisfactory
Highest Operating Temperature	60 Degrees
Fire Classification	C-s2,d0
Minimum Pitch	>4 Degrees

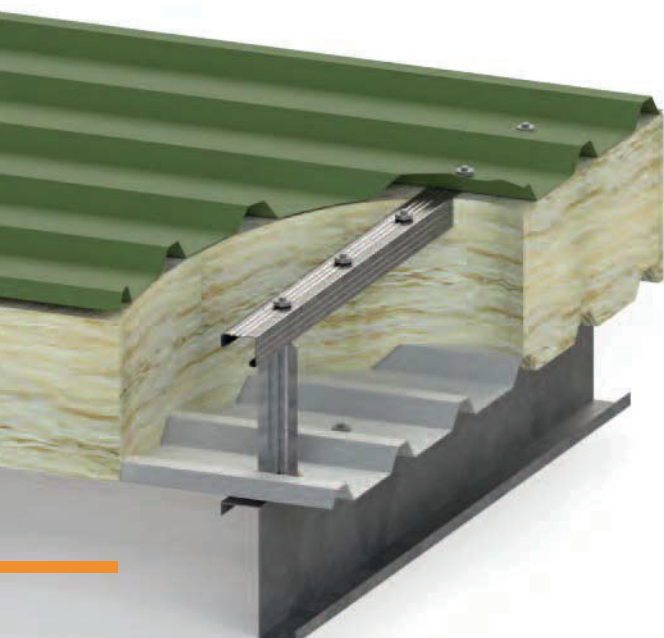

\*Guarantee subject to application, colour and location

# F200 Plastisol

## Properties

PVC resin preserving properties of plastic gives outstanding weather resistance, chemical resistance, and corrosion resistance.

Elongation of paint layer reaches up to 300-400% without any crack under very severe processing conditions. Specially embossed surface enhances product features specific appearance and guarantees 30 years of durability.

---

## Applications

Exterior Cladding Materials - Roof & Wall

---

## Base Material

GI (Hot-Dip Galvanized Steel) or ALZASTA (Hot-Dip 55% AlOZN Alloy Coated Steel)

---

## Performance

<b>Thickness</b>	Ave. 200 $\mu$ m	EN 13523-1
<b>Gloss (60°)</b>	10~35%	EN 13523-2
<b>Emboss</b>	Leather grain	
<b>Abrasion resistance (CS-10, 1kg, 250rev)</b>	10~15mg	EN 13523-16
<b>T-Bend (0T, 16°C)</b>	No crack	EN 13523-7
<b>Reverse impact</b>	18J	EN 13523-5
<b>Ball impact resistance (1/2"*500g*50cm)</b>	No crack	
<b>Coating hardness</b>	Over 100 times	M.E.K(Methyl Ethyl Ketone) Rubbing Test
<b>Fire classification</b>	C-s2,d0	EN 13501-1
<b>Corrosion resistance</b>		
• Salt spray test	1000 hours RC5	EN 10169
• Category		
<b>Humidity resistance</b>	1500 hours	
<b>UV resistance</b>	QUV-A, 1000 hours RUV3 (color deviation < 3, gloss retention > 60%)	EN 10169
<b>Resistance to acids and bases</b>	Good	